



CUSTOM CLEANING EQUIPMENT THAT REDEFINES MANUFACTURING POSSIBILITIES

With over 100 years of unwavering commitment to quality and creativity, our unparalleled solutions position the most esteemed global manufacturing companies to seamlessly operate at maximum capacity.

LEARN MORE AT MAGNUSEQUIPMENT.COM

MALH #3, #4, #5, #5.5

RECOGNIZED AS THE INDUSTRY STANDARD

The Magnus MALH series is the latest design of the original pneumatic driven platform agitation parts washer.

THOROUGH CLEANSING POWER

Continuous flushing of hard-to-reach interior areas via variable vertical agitation.

VIGOROUS CLEANING CAPABILITIES

Customizable options including particulate filtration, oil removal, & high volume liquid sparging are available to enhance the time-tested and proven platform agitation.

MODULAR BY DESIGN

The modular MALH series can be intergrated into any cleaning application as either a stand alone unit or multi-stage system. Manual or automatic load transfer available with either option.

PNEUMATIC AGITATION CONTROL

Offers short, medium, & long strokes for cleaning various part types.

SYSTEM LOAD CAPACITY

The standard MALH has a load capacity of **1000 lbs!**

PROUDLY DESIGNED & MANUFACTURED IN THE USA



MALH Machine Dimensions				
Machine Number	#3	#4	#5	#5.5
Dipping Space				
Length (L-R) (A)	41"	52"	66.25"	84.25"
Width (F-B) (B)	24"	28.25"	34"	34"
Depth (C)	26"	26"	26"	26"
Inside Tank				
Length (D)	43.75"	54.75"	69"	87"
Width (E)	44.75"	49"	54.75"	54.75"
Depth (F)	42.25"	42.25"	42.25"	42.25"
Overall Machine				
Length (Gas Heat)	62.5"	73.75"	88"	102.75"
Length (Electric/Steam Heat)	55.25"	66.5"	80.75"	98.5"
Width	60"	65"	70"	70"
Height	88.5"	88.5"	88.5"	88.5"
Grate/Roller Platform				
Length	40.5"	51"	65.75"	83.75"
Width	23.5"	27.25"	33.5"	33.5"
General Data				
Load Capacity @100 psi (lbs)	1000	1000	1000	1000
Liquid Capacity (gal)	290	400	560	710
Tank Wall Thickness (ga)	10	10	10	10
Service Connections				
Air Supply (recommended PSI)	100	100	100	100
Air Inlet (NPT)	0.5"	0.5"	0.5"	0.5"
Water Inlet (NPT)	1.25"	1.25"	1.25"	1.25"
Drain Valve (NPT)	2"	2"	2"	2"
Overflow Port (NPT)	2"	2"	2"	2"
Vapor Exhaust (Diameter)	4"	4"	6"	6"
Supply for Heat				
Electric (240V/3PH/60HZ)	61A	61A	90A	119A
Electric (480V/3PH/60HZ)	32A	32A	47A	61A
Gas (NPT)	0.75"	0.75"	0.75"	0.75"
Steam (NPT)	1"	1"	1"	1"
Utility Consumption				
Natural Gas (cu ft/hr)	115	235	257	257
Electric (kW)	24	24	36	48
Steam (lbs/hr)	85	110	175	220
Air (CFM) (All Tanks)	20-28	20-28	20-28	20-28

FRONT CROSS SECTION

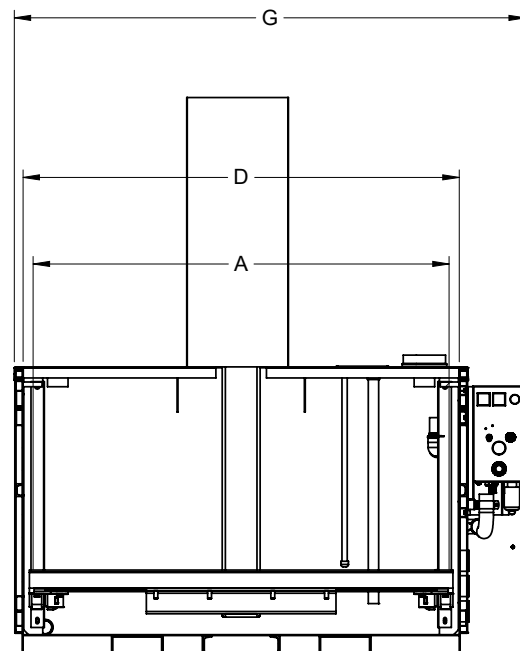

SIDE CROSS SECTION

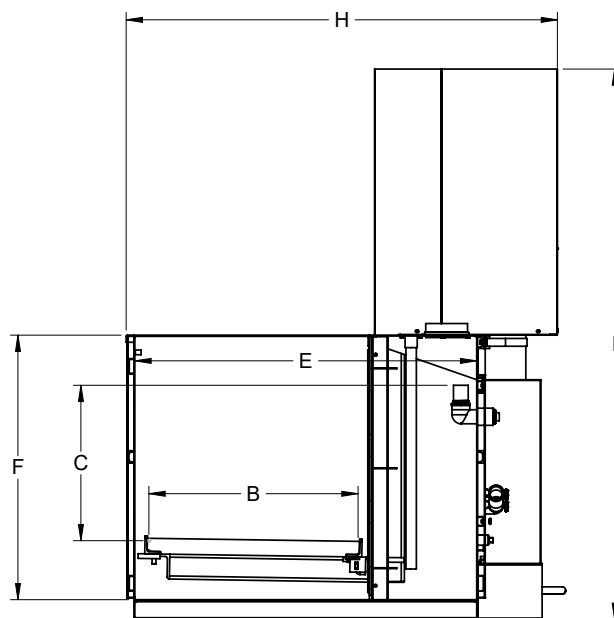

MALH Notes:

- 1 Lighter loads can operate at reduced air pressure.
- 2 Fully immersed stainless steel sheathed elements on all electrically heated units. Other voltages & phases available.
- 3 Contact factory for steam heated tank information.
- 4 The data shown is typical and may vary with air pressure, load weight, shape, and stroke length.
- 5 Maximum part height for MALH is 24" for full immersion cleaning.
- 6 A "stroke" equals travel in one direction.

PROUDLY DESIGNED,
★ MANUFACTURED, & ★
TESTED IN THE USA



440.942.8488



info@magnusequipment.com



magnusequipment.com

PRODUCT FEATURES

TANK FEATURES

- Aggressive vertical platform agitation
- Unheated, electric, or gas heated cleaning up to 2200 lbs load capacity
- Manual, hinged stainless steel tank cover
- Removable grate platform
- Can be equipped for either aqueous or solvent cleaning
- System configuration with common utility drop
- Pneumatic or electric agitation control
- Stroke length selector for short, medium & long stroke adjustment options
- Suitable for cellular manufacturing layouts
- Insulated carbon steel or stainless steel tank construction
- Liquid overflow port
- Water inlet coupling & drain valve.

OPTIONAL UPGRADES

- Turbulation
- Removable roller platform for easy load transfer
- Particulate filtration and/or oil coalescing
- Automatic tank cover
- Automatic water addition
- Low water level process lockout
- Automatic cycle timer for process control
- Programmable 7 day timer for auto tank heat up
- Partial tunnel enclosure for water vapor control
- Basket or custom load fixtures
- Load/unload roller platforms
- Plastic liner for special applications
- Pumped or gravity counter flow on multi-stage

COST EFFECTIVE OPTIONS

- Unheated cleaning
- Carbon steel tank construction
- Fixed platform with no vertical agitation for overhead loading

WHY CHOOSE MAGNUS?



A LEGACY OF QUALITY

With over **15,000 systems installed worldwide**, we constantly push to innovate while continuing to support the legacy equipment we installed decades ago. Our heritage is built on a relentless commitment to quality, engineering the right solutions for some of the toughest cleaning jobs in the world.



ENGINEERING BEYOND MANUFACTURING

We **design and manufacture American-made equipment** to precisely serve your unique needs. Whether that's a specific cleaning requirement, weight challenge, space constraint or a specialized application, we listen intently to create custom solutions that others simply can't.



CUSTOMER COLLABORATION

Your trust is priceless. When you begin a relationship with Magnus, you gain a dedicated team **who will work for you and with you**. Consider us your personal engineering expert, devoted to boosting efficiency, enhancing productivity, and driving sustainable growth far beyond your investment.

