

## CUSTOM CLEANING EQUIPMENT THAT REDEFINES MANUFACTURING POSSIBILITIES

With over 100 years of unwavering commitment to quality and creativity, our unparalleled solutions position the most esteemed global manufacturing companies to seamlessly operate at maximum capacity.

LEARN MORE AT [MAGNUSEQUIPMENT.COM](http://MAGNUSEQUIPMENT.COM)

## MLSR (MIJI-LIF™)

### RECOGNIZED AS THE INDUSTRY STANDARD

The Magnus MLSR is the latest design of the original pneumatic driven platform agitation parts washer.

### THOROUGH CLEANSING POWER

Continuous flushing of hard-to-reach interior areas via vertical agitation.

### VIGOROUS CLEANING CAPABILITIES

Customizable options including particulate filtration, oil removal, ultrasonics, & high volume liquid sparging are available to enhance the time-tested and proven platform agitation.

### MODULAR BY DESIGN

The modular ML Series can be integrated into any cleaning applications as either a stand alone unit or multi-stage system. Manual or automatic load transfer available with either option.

### PNEUMATIC AGITATION CONTROL

Offers short & long strokes for cleaning various part types.

### SYSTEM LOAD CAPACITY

The standard MLSR has a load capacity of 125 lbs.

### PROUDLY DESIGNED & MANUFACTURED IN THE USA



ML SR MACHINE DIMENSIONS	
Machine Number	SR
DIPPING SPACE	
Length (L-R) (A)	29"
Width (F-B) (B)	18"
Depth (C)	11"
INSIDE TANK	
Length (D)	30"
Width (E)	22"
Depth (F)	20.5"
OVERALL MACHINE	
Length (G)	39"
Width (H)	27.75"
Height (I)	53.75"
GRATE/ROLLER PLATFORM	
Length	28.25"
Width	17.5"
GENERAL DATA	
Load Capacity @80 psi (lbs)	125
Liquid Capacity (gal)	40
Tank Wall Thickness (ga)	12
SERVICE CONNECTIONS	
Air Supply (recommended PSI)	100
Air Inlet (NPT)	0.25"
Water Inlet (NPT)	0.75"
Drain Valve (NPT)	1.25"
Overflow Port (NPT)	1"
Vapor Exhaust (Diameter)	-
SUPPLY FOR HEAT	
Electric (240V/3PH/60HZ)	15A
Electric (480V/3PH/60HZ)	8A
UTILITY CONSUMPTION	
Electric (kW)	6
Air (CFM) (All Tanks)	2-4

FRONT CROSS SECTION

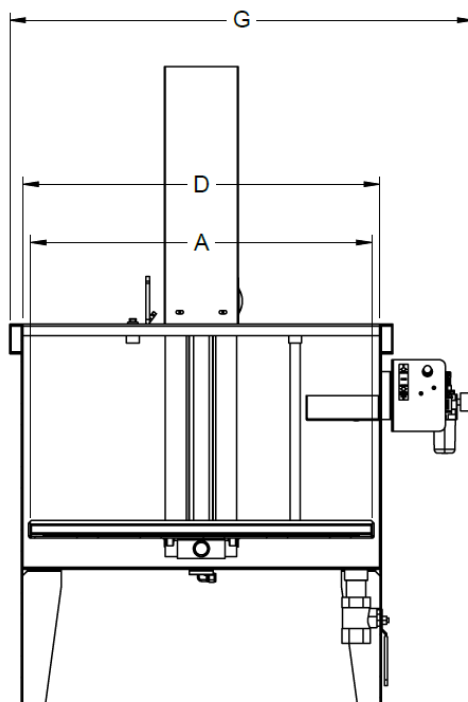

SIDE CROSS SECTION

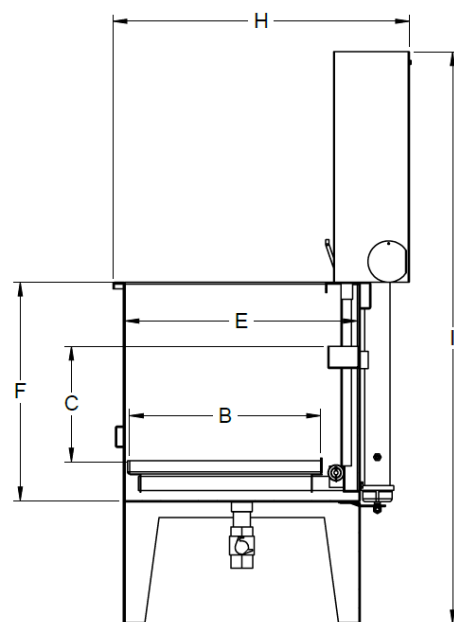

## ML SR Notes:

- 1 Dipping Depth (C) reduced by 6" when ultrasonics are installed. Request extra-deep tank to maintain full dipping depth.
- 2 Lighter loads can operate at reduced air pressure.
- 3 Fully immersed stainless steel sheathed elements on all electrically heated units. Other voltages & phases available.
- 4 The data shown is typical and may vary with air pressure, load weight, shape, and stroke length.
- 5 Maximum part height for ML SR is 9" for full immersion cleaning.
- 6 A "stroke" equals travel in one direction.

PROUDLY DESIGNED,  
★ MANUFACTURED, & ★  
TESTED IN THE USA



## PRODUCT FEATURES

### TANK FEATURES

- 304 stainless steel tank construction
- Manual, hinged 304 stainless steel tank cover
- 304 stainless steel insulation jackets & cylinder guard
- Electrically heated cleaning up to 125 lbs of parts
- Liquid overflow port
- Water inlet coupling & drain valve
- Can be equipped for either aqueous or solvent cleaning
- Pneumatic agitation control for stroke speed adjustment
- Aggressive vertical platform agitation
- Removable grate platform
- Suitable for cellular manufacturing layouts

### COST EFFECTIVE OPTIONS

- Unheated cleaning
- Carbon steel tank construction

### OPTIONAL UPGRADES

- 316 stainless steel or other tank construction materials
- Automatic tank cover
- Pumped or gravity counter flow on multi-stage
- Automatic water addition
- Automatic cycle timer for process control
- Programmable 7 day timer for auto tank heat up
- Low water level process lockout
- Partial tunnel enclosure for water vapor control
- System configuration with common utility drop
- Removable roller platform
- External load/unload roller platforms
- Basket or custom load fixtures
- Turbulation
- Plastic liner for special applications
- Cartridge or bag filtration
- Oil removal systems
- Ultrasonics available in 20 kHz
- Fusible link fire suppression aid

## WHY CHOOSE MAGNUS?



### A LEGACY OF QUALITY

With over **15,000 systems installed worldwide**, we constantly push to innovate while continuing to support the legacy equipment we installed decades ago. Our heritage is built on a relentless commitment to quality, engineering the right solutions for some of the toughest cleaning jobs in the world.



### ENGINEERING BEYOND MANUFACTURING

We **design and manufacture American-made equipment** to precisely serve your unique needs. Whether that's a specific cleaning requirement, weight challenge, space constraint or a specialized application, we listen intently to create custom solutions that others simply can't.



### CUSTOMER COLLABORATION

Your trust is priceless. When you begin a relationship with Magnus, you gain a dedicated team **who will work for you and with you**. Consider us your personal engineering expert, devoted to boosting efficiency, enhancing productivity, and driving sustainable growth far beyond your investment.

